

WILLIAM LILSON

1828

1309

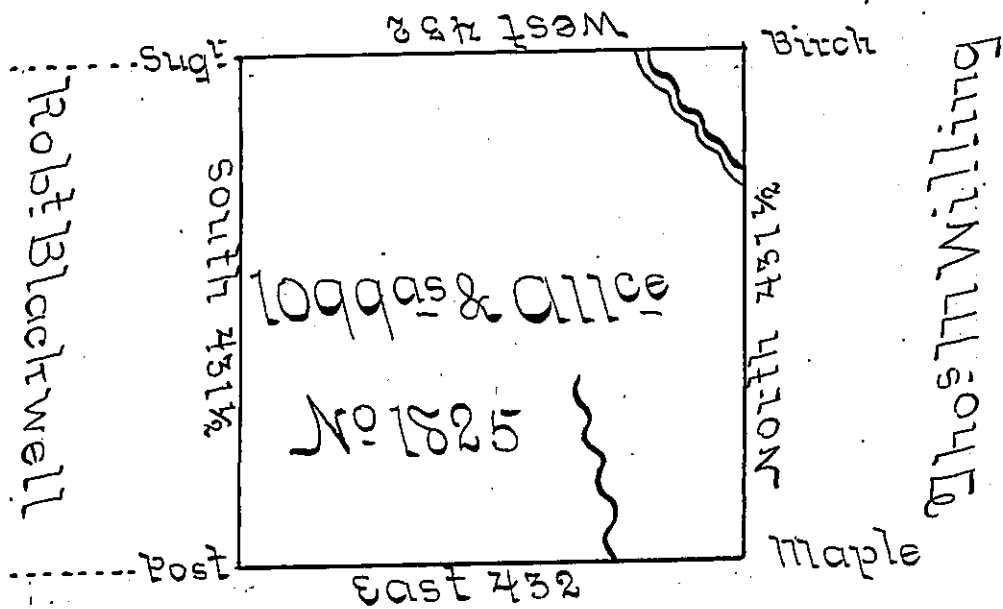

WILLIAM LILSON
1811

Thomas M Willing

1826

In pursuance of Warrant No 1825 dated 18th August 1792
 Surveyed 23^d November 1792 to Thomas M Willing the
 above described tract of land on a Branch of Pine Creek
 in the late purchase Northumberland County in dis-
 trict No 2 Containing one thousand & Ninety Nine
 acres & Allow^e of six Percent

Jno Brodhead U.S.

Daniel Brodhead Esquire }
 Surveyor General ~ }

IN TESTIMONY that the above is a copy of the original remaining on file in
 the Department of Internal Affairs of Pennsylvania, made
 conformably to an Act of Assembly approved the 16th day of
 February, 1833, I have hereunto set my Hand and caused
 the Seal of said Department to be affixed at Harrisburg,
 this fourth day of December 1900.

James W. Fatta
 Secretary of Internal Affairs.